

## S. 50-908

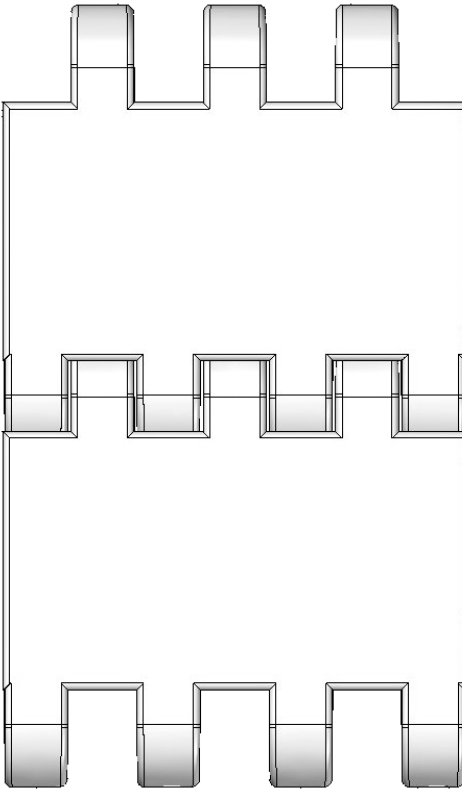

Belt data		
Materials	Max. belt pull kg/m of width	Belt weight kg/m <sup>2</sup>
Polyethylene (PE)	4800	13
Polypropylene (PP)	6000	14
Polyacetal (POM)	10250	21

**Belt surface:** Closed flat top.  
**Open area:** Closed.  
**Strength:** The right belt for very heavy applications.  
**Material/colour:** PP, POM/black.  
**Cleanability:** Good.  
**Accessories:** 25 mm flight, 50, 60 mm comb flight  
**Application:** Very heavy transportation.  
 Assembling belt for cars.  
 Truck loading systems.  
**Standard widths:** Increments of 20 mm, e.g. 100, 120 mm etc

Sprocket Data								
No. of teeth	A= Outside diameter	B= Pitch-diameter	C= Inside-diameter	Hub width:	Round bore		Square bore	
					mm	in.	mm	in.
12	210	191	172	40	40/60		60/80/90	
16	273	254	235	40	40/60		60/80/90	
18	307	288	269	40	40/60		60/80/90	

